

## A. Technical infomations

### 1. Housing / Mounting

Product code	LEDEUD00076S40	LEDEUD00077S40
Body	Aluminum body	
Finishing	White	
Lighting outlet	1	
Type of installation	Recessed downlighting / Recessing hole Ø 150 mm	
Net weight	1365g	
Electrical class	Class I	
IP rating	IP20	
LED module	Replaceable	
Glow wire temp	850°C	
Approval Mark	CE	
Ambient temperature range	+5°C -> 35°C	

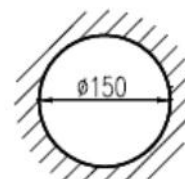
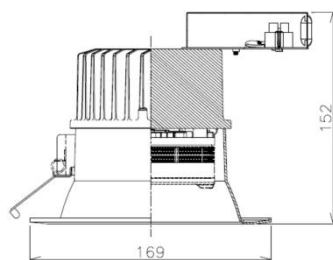

Recessing Hole Diameter  
Ceiling Thickness: 5~37mm

### 2. Electrical features / Control

Product code	LEDEUD00076S40	LEDEUD00077S40
Rated Voltage ( V )	220-240 AC	
Frequency ( Hz )	50 / 60	
Wattage ( W )	18	23
Input Current ( A )	0,090	0,109
Power Factor	0.7	
Dimming	Yes, Phase Control (trailing-edge) via power line	
Connection	3 * (0.8-1.8) mm <sup>2</sup>	

**3. Optical features**

Product code	LEDEUD00076S40	LEDEUD00077S40																																										
Beam angle	90°																																											
Ra	80																																											
UGR	25																																											
Colour Temperature	4000K																																											
Photometric class	0.96C																																											
System lumen output	1040 lm	1560 lm																																										
Lifetime ( h )	40 000h																																											
Luminous intensity (cd/1000lm)																																												
Illuminance	<table border="1"> <thead> <tr> <th>h (m)</th> <th>Ø (m)</th> <th>L (lx)</th> </tr> </thead> <tbody> <tr> <td>0.5</td> <td>1.01</td> <td>E(0°) 2073 E(C0) 45.4° 361</td> </tr> <tr> <td>1.0</td> <td>2.03</td> <td>E(0°) 518 E(C0) 45.4° 90</td> </tr> <tr> <td>1.5</td> <td>3.04</td> <td>E(0°) 230 E(C0) 45.4° 40</td> </tr> <tr> <td>2.0</td> <td>4.06</td> <td>E(0°) 130 E(C0) 45.4° 23</td> </tr> <tr> <td>2.5</td> <td>5.07</td> <td>E(0°) 83 E(C0) 45.4° 14</td> </tr> <tr> <td>3.0</td> <td>6.08</td> <td>E(0°) 58 E(C0) 45.4° 10</td> </tr> </tbody> </table>	h (m)	Ø (m)	L (lx)	0.5	1.01	E(0°) 2073 E(C0) 45.4° 361	1.0	2.03	E(0°) 518 E(C0) 45.4° 90	1.5	3.04	E(0°) 230 E(C0) 45.4° 40	2.0	4.06	E(0°) 130 E(C0) 45.4° 23	2.5	5.07	E(0°) 83 E(C0) 45.4° 14	3.0	6.08	E(0°) 58 E(C0) 45.4° 10	<table border="1"> <thead> <tr> <th>h (m)</th> <th>Ø (m)</th> <th>L (lx)</th> </tr> </thead> <tbody> <tr> <td>0.5</td> <td>1.00</td> <td>E(0°) 3165 E(C0) 44.9° 565</td> </tr> <tr> <td>1.0</td> <td>1.99</td> <td>E(0°) 791 E(C0) 44.9° 141</td> </tr> <tr> <td>1.5</td> <td>2.99</td> <td>E(0°) 352 E(C0) 44.9° 63</td> </tr> <tr> <td>2.0</td> <td>3.99</td> <td>E(0°) 198 E(C0) 44.9° 35</td> </tr> <tr> <td>2.5</td> <td>4.98</td> <td>E(0°) 127 E(C0) 44.9° 23</td> </tr> <tr> <td>3.0</td> <td>5.98</td> <td>E(0°) 88 E(C0) 44.9° 16</td> </tr> </tbody> </table>	h (m)	Ø (m)	L (lx)	0.5	1.00	E(0°) 3165 E(C0) 44.9° 565	1.0	1.99	E(0°) 791 E(C0) 44.9° 141	1.5	2.99	E(0°) 352 E(C0) 44.9° 63	2.0	3.99	E(0°) 198 E(C0) 44.9° 35	2.5	4.98	E(0°) 127 E(C0) 44.9° 23	3.0	5.98	E(0°) 88 E(C0) 44.9° 16
h (m)	Ø (m)	L (lx)																																										
0.5	1.01	E(0°) 2073 E(C0) 45.4° 361																																										
1.0	2.03	E(0°) 518 E(C0) 45.4° 90																																										
1.5	3.04	E(0°) 230 E(C0) 45.4° 40																																										
2.0	4.06	E(0°) 130 E(C0) 45.4° 23																																										
2.5	5.07	E(0°) 83 E(C0) 45.4° 14																																										
3.0	6.08	E(0°) 58 E(C0) 45.4° 10																																										
h (m)	Ø (m)	L (lx)																																										
0.5	1.00	E(0°) 3165 E(C0) 44.9° 565																																										
1.0	1.99	E(0°) 791 E(C0) 44.9° 141																																										
1.5	2.99	E(0°) 352 E(C0) 44.9° 63																																										
2.0	3.99	E(0°) 198 E(C0) 44.9° 35																																										
2.5	4.98	E(0°) 127 E(C0) 44.9° 23																																										
3.0	5.98	E(0°) 88 E(C0) 44.9° 16																																										

# PACK omni

## B. 1. Logistic data

Product code	EAN Code	Description	Size of Packaging (L * H * W) (mm)	Gross weight (g)
LEDEUD00076S40	4974550441384	Pack omni 18W 4000K	290 * 215 * 187	1400
LEDEUD00077S40	4974550441391	Pack omni 23W 4000K	290 * 215 * 187	1400

## 2. Packaging content

- LED module and fixture
- Fixing system
- Instruction sheet

## C. Important note

### 1. Customization

Can be customized according:

- CCT: 2700, 3000 and 4000K
- Beam angle: 90° or Medium Flood
- Dimming: phase control (trailing-edge) or 1-10V

Please contact your representative for further information.

### 2. Fixture w/o LED module

Product code	EAN Code	Description	Size of Packaging (L * H * W) (mm)	Gross weight (g)
LEDEUD00075C	4974550441377	Aluminum Body Downlight	290 * 215 * 187	1200

Please contact your representative for further on LED-module spare-parts.